

SUPPORTING RESIDENCES FOR STUDENTS OF HOSEI UNIVERSITY

2024

For International students



PARTNERSHIP WITH
KYORITSU MAINTENANCE CO, LTD.



About our student dormitories

1. Daily Meals

Each dormitory has a kitchen, and homemade breakfast and supper are provided everyday (Except Sundays, National Holidays, the 5th Saturday, Summer Holiday and Winter Holiday) to support health of busy student's. You can save time for cooking and washing dishes. You will enjoy fresh meals using your time effectively! You can choose Japanese or Western menu for breakfast.

*Last order time for breakfast is 15minutes before the closing time, and that for dinner is 30minutes before the closing time.

*Attention: It's not possible to respond to your personal requests according to your allergy or religious restriction. Vegetarian / religious menu such as halal are not available.



2. Facilities & Equipment

Students do not need to buy or bring their own furniture because necessary fixtures and furniture for daily life are provided, which saves you the cost of moving. Each room is furnished with a bed, desk, chair, air-conditioner, bookshelf, closet or chest, and lamp. Each room has 24 hour dedicated Internet connection.

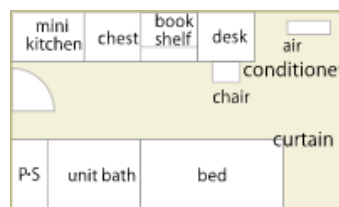

3. Common Facilities

Our dorm has many common facilities. You can use not only the dining room, kitchen, public bath, laundry room and private shower room but also the electric appliances such as a vacuum cleaner and an iron.

*Actual equipment may differ from the images.



4. Safety Management

Dormitory managers help residents with their daily life, and cares about their health condition and security. When you're sick, or when a package for you needs to be received while you are out, they will support you.



We hope our dormitory would be a place that gives many opportunities to interact with other languages and cultures in your daily life.

■ Recommended Dormitories: Ichigaya Campus

Dormy Nakakasai Grobal House (For Women & Men)



Dorm Hours

Curfew: No Curfew
Breakfast: 7am~8:30am
Dinner: 6pm~10pm

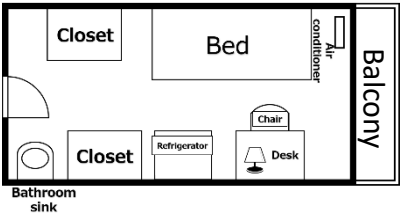

*This website is in Japanese, but you can see what the dormitory looks like from the pictures.

Access: Approximately 6 minutes walk from "Kasai" Station of Tokyo subway Tozai Line
Address: 3-20-8, Nakakasai, Edogawa-ku, Tokyo
Room size: 13.80m² / Capacity : 144 people



Application fee (one time)	Security deposit	¥50,000
	Entrance fee	¥100,000
	Building maintenance fee	¥3,000
Total of application fee		¥153,000
Monthly fee	Rent	¥76,200
	Internet facility(Wi-Fi)	¥3,960
	Electricity fee	¥7,150
	Monthly management fee	¥6,000
Total of monthly fee		¥93,310
Leaving dormitories	Room cleaning fee	¥39,600

*The prices shown here are as of December 2023. Prices are subject to change.

Dormy Kasai Grobal house (For Men)



Dorm Hours

Curfew: No Curfew
Breakfast: 7am~8:30am
Dinner: 6pm~10pm

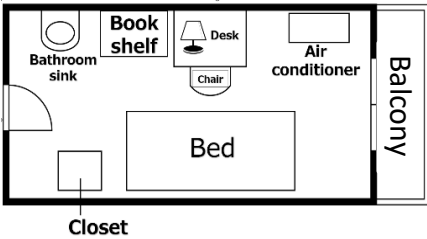

*This website is in Japanese, but you can see what the dormitory looks like from the pictures.

Access: Approximately 10 minutes walk from "Kasai" Station of Tokyo subway Tozai Line
Address: 6-8-6, Nakakasai, Edogawa-ku, Tokyo
Room size: 11.34m² / Capacity : 88 people



Application fee (one time)	Security deposit	¥50,000
	Entrance fee	¥100,000
	Building maintenance fee	¥3,000
Total of application fee		¥153,000
Monthly fee	Rent	¥76,200
	Internet facility(Wi-Fi)	¥3,960
	Electricity fee	¥7,150
	Monthly management fee	¥6,000
Total of monthly fee		¥93,310
Leaving dormitories	Room cleaning fee	¥39,600

*The prices shown here are as of December 2023. Prices are subject to change.

We have other dormitory options to offer!

■ Recommended Dormitories: Koganei campus

Hosei University Higashi-Koganei Dormitory (For Men)

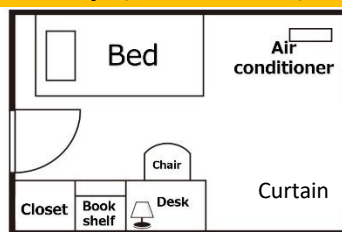

Higashi-Koganei dormitory

About 8 min by walking



Access: Approximately 15 min. walk from "Higashi-Koganei Station" of JR Chuo Line

Address: 2-15-2, Kajinocho, Koganeishi, Tokyo

Room size: 13.77m² / Capacity 57 people

Dorm Hours

Curfew: No Curfew

Breakfast: 7am ~8:30am

Dinner: 6pm ~10pm



*This website is in Japanese, but you can see what the dormitory looks like from the pictures.

Application fee (one time)	Security deposit	¥50,000
	Entrance fee	¥100,000
	Building maintenance fee	¥3,000
Total of application fee		¥153,000
Monthly fee	Rent	¥76,200
	Internet facility(Wi-Fi)	¥3,960
	Electricity fee	¥7,150
	Monthly management fee	¥6,000
Total of monthly fee		¥93,310
Leaving dormitories	Room cleaning fee	¥39,600

*The prices shown here are as of December 2023. Prices are subject to change.

Dormy Koganei (For Women)

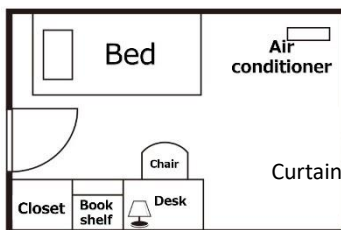

Musashi-Koganei Sta.

About 26 min by bus



Access: Approximately 12 min walk from "Musashi Koganei Station" of JR Chuo Line

Address: 3-3-23, Nukuiminami-cho, Koganei-shi, Tokyo

Room size: 9.72m² / **Capacity:** 39 people

Dorm Hours

Curfew: No Curfew

Breakfast: 7am ~8:30am

Dinner: 6pm ~10pm



*This website is in Japanese, but you can see what the dormitory looks like from the pictures.

Application fee (one time)	Security deposit	¥50,000
	Entrance fee	¥100,000
	Building maintenance fee	¥3,000
Total of application fee		¥153,000
Monthly fee	Rent	¥71,200
	Internet facility(Wi-Fi)	¥3,960
	Electricity fee	¥7,150
	Monthly management fee	¥6,000
Total of monthly fee		¥88,310
Leaving dormitories	Room cleaning fee	¥36,300

*The prices shown here are as of December 2023. Prices are subject to change.

■ Recommended Dormitories: Tama Campus

Hosei University Nishi-Hachioji Dormitory (For Women & Men)



Access: Approximately 12 min. walk from
"Nishi-hachioji Station" of JR Chuo Line

Address: Moto Hongo-cho, Hachioji-shi, Tokyo

Room size: 18.00m² / Capacity 72 people

Dorm Hours

Curfew: No Curfew
Breakfast: 7:00AM ~ 8:30AM
Dinner: 6:00PM ~ 10:00PM

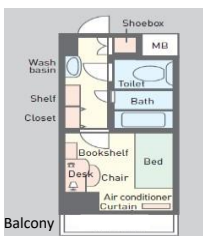

*This website is in Japanese, but you can see what the dormitory looks like from the pictures.



About
22 min
by bus



APPLICATION FEE (One Time)	Security Deposit	¥ 50,000
	Entrance Fee	¥ 180,000 (1year) ¥ 230,000 (2 years) ¥ 300,000 (3years) ¥330,000 (4years)
	Annual Maintenance Fee	¥ 228,000
	Building Maintenance Fee	¥ 3,000/year
	Room Cleaning Fee	¥ 47,300
TOTAL OF APPLICATION FEE		¥ 484,300 ~ ¥ 634,300
MONTHLY FEE	Rent	¥ 89,000 with meals ¥ 71,400 without meals
	Internet Facility	¥ 3,960
	Electricity Fee	Direct contract with A power company
	Water bill	¥ 1,650
TOTAL OF MONTHLY FEE		¥ 77,010 or ¥ 94,410 ~

*The prices shown here are as of December 2023. Prices are subject to change.

Dormy Takao (For Women & Men)



Access: Approximately 2 min. walk from
"Takao Station" of JR Chuo Line

Address: Hatuzawa-machi, Hachioji-shi, Tokyo

Room size: 12.50m² / Capacity: 522 people

Dorm Hours

Curfew: No Curfew
Breakfast: 7:00AM ~ 8:30AM
Dinner: 6:00PM ~ 10:00PM

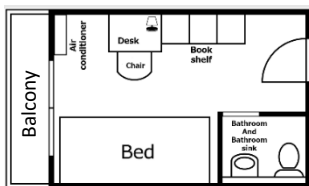

*This website is in Japanese, but you can see what the dormitory looks like from the pictures.

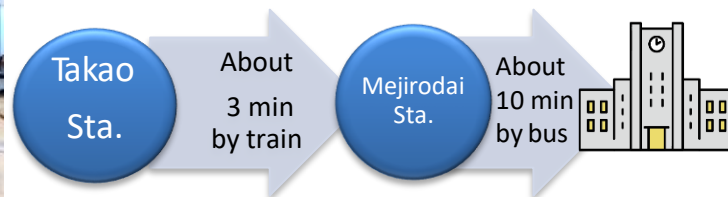

Application fee (one time)	Security deposit	¥ 50,000
	Entrance fee	¥ 100,000
	Building maintenance fee	¥ 3,000
Total of application fee		¥ 153,000
Monthly fee	Rent	¥ 76,200
	Internet facility(Wi-Fi)	¥ 3,960
	Electricity fee	¥ 7,150
	Monthly management fee	¥ 6,000
Total of monthly fee		¥ 93,310
Leaving dormitories	Room clearing fee	¥ 47,300

*The prices shown here are as of December 2023. Prices are subject to change.

We have other dormitory options to offer!

■ Lease Futon(Japanese Bed)・TV・Fridge



<LCD TV>
 3 months : ¥11,000
 6 months : ¥15,950
 12 months : ¥25,300

< Fridge >
 3 months : ¥11,000
 6 months : ¥14,300
 12 months : ¥20,900

<Futon(Bedding set) >



Period	Price
4 months	¥14,960
6 months	¥18,920
8 months	¥22,880
10 months	¥26,840
12 months	¥30,800

* Bed sheets exchange are provided three times a month.

■ HOW TO APPLY

SEND US AN E-MAIL

- Please e-mail to int@gakuseikaikan.com giving the following info:
 ①Your name ②Nationality ③TEL ④E-mail address ⑤Department of Hosei University ⑥Month for moving-in ⑦Estimated contract period

SEND US AN APPLICATION

- Kyoritsu Maintenance Co., Ltd. will send you an official application form to your e-mail address. Please read our cancellation policy, and if you agree with it please send it back by e-mail after filling out.

INVOICE WILL BE SENT

- After your qualifications are approved, we will assign your dormitory and send you the result and an invoice. You will be asked to wire the initial cost to our bank account.

INITIAL PAYMENT

- After you pay the initial cost, your contract will be validated officially and cancellation charge is applicable.

MOVE INTO THE DORM

- You move into your dormitory. Check-in time is from 10:00AM to 8:00PM everyday except Sundays, Japanese national holidays, and dormitory holidays.

SIGN UP THE CONTRACT

- Please participate in a dormitory orientation to sign up the contract.

【Application & Inquiries】

Kyoritsu Maintenance Co., Ltd.

Customer Center, International Dept.

TEL +81-3-5295-7889 Fax: +81-3-5295-5906

E-mail: int@gakuseikaikan.com

If you are not an international student, please visit our website in Japanese. ⇒ hosei-dormitory.com



English website



Japanese website